

Pai aki
better together

DISCOVER THE SOUL OF TĀMAKI MAKAURAU AUCKLAND

**Choose Auckland New Zealand
for your next conference**

RATIONALE

Why Auckland, New Zealand



Welcome to Auckland, New Zealand – a vibrant harbour city where dynamic urban energy meets breathtaking natural beauty, world-class infrastructure, and the living spirit of Māori culture.

A hub of bold thinkers and world-firsts, New Zealand's spirit of innovation fuels globally recognised expertise and leadership across key industries.

Auckland offers an exceptional setting for business events—sophisticated venues, a walkable urban oasis, and a mild, year-round climate. Every gathering is elevated by manaakitanga—our uniquely Kiwi tradition of warm, genuine hospitality.

Unique, inspiring, and distinctly New Zealand experiences at exceptional value are never far away. This is your gateway to the extraordinary.

Safe, accessible, and seamlessly connected to the world, New Zealand is closer than you think and unlike anywhere else on earth.



Taonga Tuku Iho
Our symbol for handing on cultural, knowledge and intellectual capital.

ACCESSIBLE NEW ZEALAND

Internationally connected



60

Countries and territories have a visa waiver agreement with New Zealand

569

Direct weekly international flights to Tāmaki Makaurau Auckland.

27

International airlines fly direct to Tāmaki Makaurau Auckland from 43 destinations across the world.

Aotearoa New Zealand is just a meal, movie, and sleep away. It's the ultimate conference destination worth every extra air mile.

Tāmaki Makaurau Auckland is the most accessible and well-connected hub in Oceania, especially for delegates travelling from Asia and North America.

From Asia, it offers the highest number of direct flights in the region, including ten major Chinese cities. Multiple low-cost carriers and strong airline competition make travel affordable and convenient.

From North America, Tāmaki Makaurau Auckland leads Oceania in nonstop routes, consistent fares, frequency, and seat capacity.

Auckland Airport handles over 76% of international arrivals and connects easily to domestic destinations with frequent daily flights.

DESTINATION

A desirable destination

1st

MOST LIVEABLE CITY IN THE WORLD

Economist's Intelligence Unit (EIU)
Global Liveability Index 2021

NEW ZEALAND RANKS

1st

NATIONAL GEOGRAPHIC

TOP LONG-HAUL DESTINATION 2022

National Geographic UK

TOP 10

Friendliest cities in the world

Condé Nast Traveler Readers' Choice Awards 2021

AUCKLAND NAMED

BEST

MICE DESTINATION

IN OCEANIA

FOR 4 CONSECUTIVE YEARS

World Meeting, Incentive, Conference, Exhibition (MICE) Awards 2020-2023

AUCKLAND RANKS

1st

IN THE

CONDÉ NAST

23 PLACES TO GO IN 2023

lonely planet™

TOP CITY AUCKLAND

BEST IN TRAVEL 2022

SAFE 

Friendly Destination

Support at the highest level



“Auckland offers comprehensive support to ensure the success of every business event.”

Annie Dundas
Director Destination
Tātaki Auckland Unlimited



I would officially like to invite you to Auckland, New Zealand.

With a culturally diverse population, Auckland is the financial and economic powerhouse of New Zealand, contributing 38 per cent of the national gross domestic product.

Tātaki Auckland Unlimited is Auckland’s cultural, events and destination agency. We enrich Auckland's cultural life and vibrancy through inspirational experiences, activations and events that bring our region's unique identity and spirit to life.

As a destination, Auckland has an exciting combination of magnificent scenery, including stunning harbours and islands, native forests, black-sand beaches alongside a vibrant city lifestyle – delivering an exceptional array of tourism and Māori cultural experiences, fine food and wine, major and cultural events, and world-class facilities.

Auckland’s compact city centre means everything is in close proximity, with a range of accommodation available for all budgets, along with attractions and conference venues, all within easy reach.

You can be assured of thorough professionalism and strong support for your event in Auckland, coupled with our unique personal touch which will make your event a highly memorable and successful experience.

We look forward to seeing you soon.

Yours sincerely

Annie Dundas
Director Destination
Tātaki Auckland Unlimited

HOW WE WILL HELP

Contributions and logistical support

We're here to make your event extraordinary.

From expert advice on venues and accommodation to customised itineraries, site inspections, and trusted supplier referrals—we offer end-to-end support to bring your event vision to life.

Access funding assistance, marketing materials, along with full site inspection support on the ground.

Additional support from Tourism New Zealand, based on program inclusions. This could include return flights to New Zealand to conduct a site visit. A suite of assets to promote event activity including white label video, maps, info sheets and imagery.

PCO or DMC services, support and advice for program planning and site inspections.

Our team is here to help you deliver an unforgettable event—seamlessly and confidently.



New Zealand International Convention Centre (NZICC)



**NEW ZEALAND RANKED
1ST IN THE WORLD FOR
EASE OF DOING BUSINESS**
WORLD BANK 2020

NZICC Hobson Street View

Located in the heart of Auckland City, the NZICC is one of the most connected convention centres in the world.

- A venue that is designed around giving delegates fast and effortless transitions between meeting, exhibition, pre-function, banquet and performance spaces.
- A glazed facade providing delegates with an inviting and transparent connection to the vibrancy of the city, while allowing views of Auckland's natural beauty.
- Close proximity to Auckland's innovation ecosystem—universities, business headquarters and innovation hubs—allowing event organisers to tap into New Zealand's leading knowledge centres.
- An integrated atrium and public laneway encouraging networking and enhancing the delegate experience within a city full of excitement and sophistication, with plentiful accommodation, dining precincts, shopping and entertainment all within walking distance.
- Convention and event capacity for up to 4,000 people across 32,500 m². The configurable spaces over 4 levels present opportunities for a wide range of events including theatre capacity for 2,850, up to 33 meeting rooms and multipurpose and carpeted 6,674sqm divisible hall ideal for exhibitions.

CONFERENCE VENUES

Elevate Your Experience: Making Meaningful Connections at NZICC

**LOWEST FOOTPRINT
AND
GREATEST IMPACT**

NZICC Corner of Nelson and Wellesley St View

NZICC is set to redefine the convention experience in Aotearoa.

As the country's largest convention centre, it aims to create positive change by highlighting New Zealand's unique culture and local products. By building strong partnerships, NZICC provides genuine cultural experiences right in the heart of Auckland city. NZICC understands that a delegate's experience goes beyond the event itself. It considers the overall impact of each visit — from travel footprints to the lasting connections made.

The centre's commitment to achieving science-based, evidence-backed certifications is built into a comprehensive sustainability framework that sits at the heart of its operations. This strategy ensures the lowest environmental footprint and the biggest positive impact.

By creating meaningful experiences that benefit the community and inspire delegates, NZICC ensures every event leaves a lasting positive mark.

CONFERENCE VENUES

Cross sectional view

[CLICK HERE TO WATCH NZICC VIDEO](#)

[CLICK HERE TO VIEW NZICC
INTERACTIVE FLOORPLANS](#)

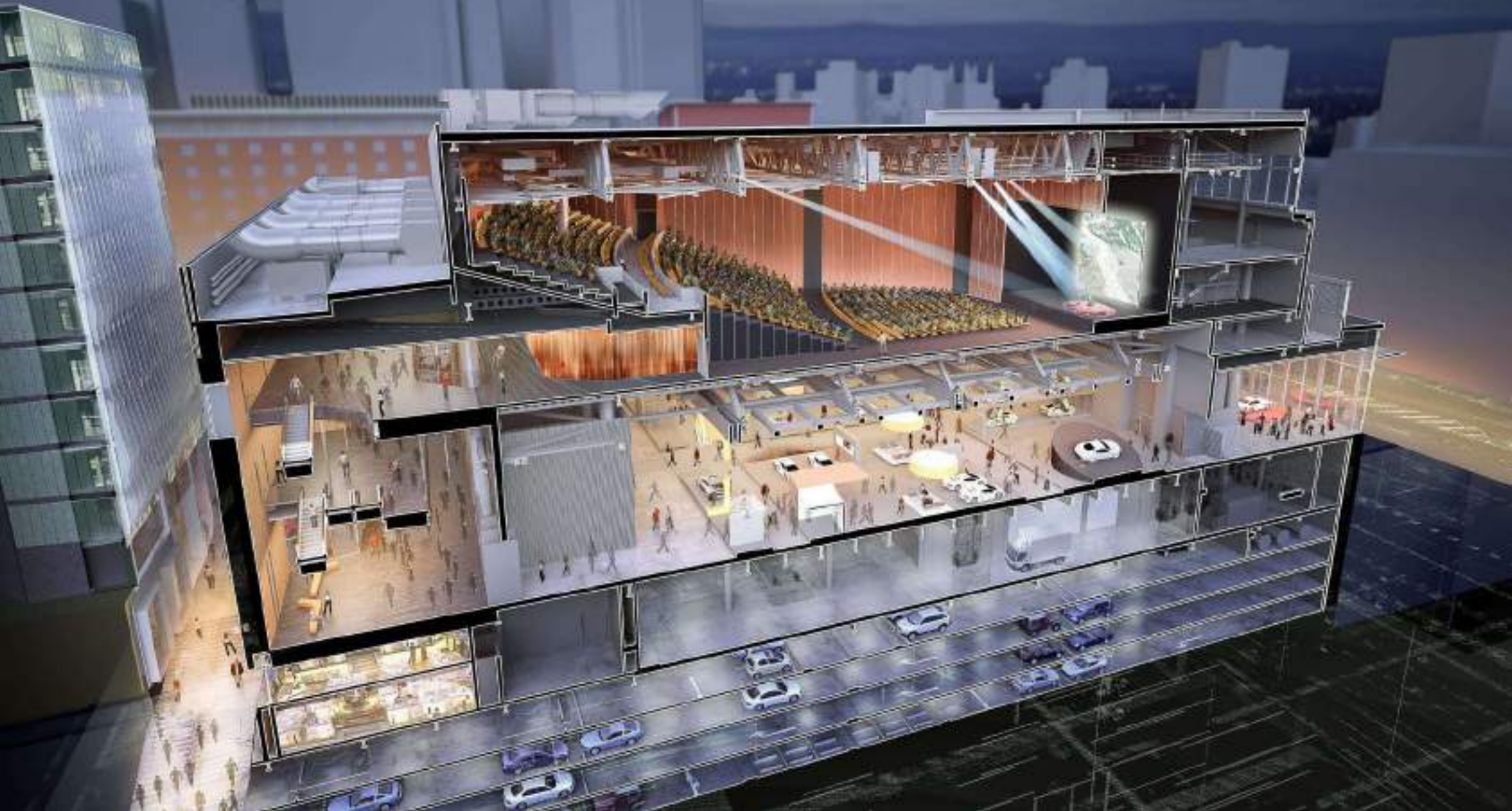

CONFERENCE VENUES

Aotea Centre



Aotea Centre, in the heart of the Aotea Arts Quarter, offers flexible spaces ideal for large-scale events—including the Kiri Te Kanawa Theatre, which seats up to 2,139 guests auditorium-style. Versatile options like the Hunua Rooms are perfect for breakouts or exhibitions. Guests enjoy easy access to nearby hotels, public transport, and Auckland's vibrant dining scene just steps away.

CONFERENCE VENUES

Cordis, Auckland



Cordis, Auckland is a sophisticated urban retreat with 461 spacious rooms and suites designed for comfort and style. Featuring 18 versatile event spaces—including The Great Room that can accommodate 1,150 guests theatre style. Guests can relax in the award-winning spa, heated outdoor pool, sauna, fitness centre, and exclusive Club Lounge. Dining highlights include Eight Restaurant and the vibrant Our Land Is Alive Bar, offering exceptional cuisine and warm hospitality.

CONFERENCE VENUES

Four Points by Sheraton



Four Points by Sheraton



Four Points by Sheraton Auckland is a modern central-city hotel featuring 255 rooms. The property offers two dedicated event spaces, the largest — the Queen's Head Ballroom accommodates up to 180 guests theatre-style. Guests can stay active in the fitness centre, visit The Churchill rooftop bar with panoramic city views and a standout gin collection and dine at the ground-level Queen's Head Bar & Eatery, serving contemporary meals in a relaxed setting.

CONFERENCE VENUE

Grand Millennium Auckland



Grand Millennium Auckland



Grand Millennium Auckland is a premium central-city hotel with 452 stylish rooms and suites. It offers some of the city's largest conference facilities, featuring 16 flexible event spaces, including a stunning Ballroom for up to 800 guests theatre-style. Guests can unwind in the heated indoor pool, well-equipped gym, and sauna. Dining options include Katsura Japanese Restaurant, known for authentic cuisine and fresh flavours, and Ember, serving contemporary dishes in a sophisticated yet welcoming setting.

CONFERENCE VENUES

Hilton, Auckland



Hilton, Auckland



Hilton Auckland blends heritage charm with modern luxury. Its 230 stylish rooms and suites offer stunning harbour views. The hotel features 7 function spaces, including the Anchorage Room, which seats 280 theatre-style—perfect for elegant events. Guests can relax at the rooftop pool and fitness centre, then enjoy signature dining at FISH Restaurant or cocktails at Bellini Bar, all with impeccable service and beautiful waterfront views.

CONFERENCE VENUES

JW Marriott, Auckland



JW Marriott, Auckland



JW Marriott Auckland is a luxury escape in the heart of the city, offering 286 elegant guest rooms, including 15 suites with sweeping city views. With 7 flexible function spaces, including a pillarless ballroom for up to 320 guests theatre style, it's ideal for unforgettable events. Rejuvenate in the 10th-floor Wellness Centre featuring a heated pool, sauna, and fitness centre. Dine and unwind at Trivet Restaurant, Forum Bar, and the exclusive Executive Club Lounge.

CONFERENCE VENUES

M Social



M Social



M Social Auckland is a stylish waterfront hotel offering 190 contemporary rooms. The property features small meeting rooms, the largest Catalyst 4 accommodating up to 60 guests theatre-style. Guests can stay active in the well-equipped fitness centre and dine at Beast & Butterflies, which serves Pacific-Rim street-food inspired cuisine with fresh local seafood.

CONFERENCE VENUES

Mövenpick Hotel Auckland



Mövenpick



Mövenpick Hotel Auckland blends Swiss-inspired luxury with a vibrant waterfront location. Its dedicated conference floor offers eight versatile meeting spaces, including the Hauraki Gulf Room, hosting up to 200 delegates theatre-style. Custom Lane Café, with its eclectic street art vibe, is also available for private functions. Guests can savour modern Korean fusion at BODA Restaurant & Bar with panoramic city views, or recharge in the fitness centre and yoga room.

CONFERENCE VENUES

Park Hyatt Auckland



Park Hyatt Auckland offers sophisticated waterfront luxury with 195 rooms and suites boasting harbour or city views. Boasting five event spaces, including The Harbour Room for up to 330 theatre-style guests and the Waka Rooftop provides an exclusive setting for cocktails. Guests enjoy the on-site spa, heated infinity pool, and fitness centre. Dining highlights include Onemata and The Captains Bar, known for premium rums and classic cocktails.

CONFERENCE VENUES

Pullman Auckland



Pullman Auckland is a premium inner-city hotel with 324 contemporary rooms and suites. Featuring 16 versatile event spaces, including the Princes Ballroom accommodating up to 1,000 guests theatre style. Guests can unwind at the luxurious Pullman Spa, 25-metre heated indoor pool, sauna, and modern fitness centre. Culinary offerings include Tapestry Grill & Bar, serving modern New Zealand cuisine with global flair in a relaxed yet stylish setting.

CONFERENCE VENUES

QT Auckland



QT Auckland



QT Auckland is a stylish, design-forward hotel located close to the waterfront with 150 rooms. The property's largest function space the Limáni Room accommodates up to 80 guests theatre-style. Guests can enjoy the fitness centre, unwind at the rooftop bar with harbour and city-scape views, and dine at the signature restaurant Esther, led by celebrity Chef Sean Connolly, specialising in Mediterranean-inspired cuisine with a fresh, local twist.

CONFERENCE VENUES

Rydgēs Auckland



Rydgēs Auckland



Rydgēs Auckland is an urban hotel offering 267 guest rooms in the heart of the city. The property features 12 flexible event spaces, with the largest Kingston Rooms accommodating up to 250 guests theatre-style. Guests can stay active in the well-equipped fitness centre and dine at CUT Restaurant & Bar, specialising in modern New Zealand cuisine with a focus on prime cuts of beef and fresh, locally sourced produce.

CONFERENCE VENUES

Sofitel Auckland Viaduct Harbour



Sofitel Auckland Viaduct Harbour is a luxurious waterfront hotel offering 91 rooms. The property features 4 event spaces with the largest the Boulevard Room accommodating up to 130 guests theatre style. Guests can relax in the spa, unwind in the lap pool and stay active in the fitness centre. Dining highlights include La Marée offering French-New Zealand fusion cuisine in an elegant setting overlooking the marina.

CONFERENCE VENUES

SO/ Auckland



SO/ Auckland



SO/ Auckland is a bold, design driven urban hotel offering 130 rooms with sweeping harbour or city views. The properties largest event space The Vault accommodates up to 145 guests theatre style. Guests can relax in the 20-metre indoor lap pool, sauna and jacuzzi or stay active in the 24-hour fitness centre. Dining highlights include Harbour Society, serving Asian inspired cuisine and HI-SO Rooftop Bar, an energetic open air venue offering creative cocktails and panoramic views.

CONFERENCE VENUES

Sudima Auckland City



Sudima Auckland City



Sudima Auckland City is a contemporary hotel with a strong focus on sustainability, offering 194 stylish rooms, many with harbour or city views. The Waitemata event space accommodates up to 80 guests theatre style. Guests can dine at East, the award-winning plant-based restaurant serving innovative Asian-fusion cuisine. The rooftop Sunset Bar offers panoramic harbour views, creative cocktails, and Mumbai-inspired share plates.

CONFERENCE VENUES

voco Auckland City Centre



voco Auckland City Centre offers 201 thoughtfully designed rooms blending comfort and style. The largest event space, Korimako (Bellbird), accommodates up to 70 guests theatre style. Guests can dine at Mozzarella & Co., a ground-floor Italian trattoria, then head to Bar Albert — New Zealand's highest hotel rooftop bar — for panoramic city views and signature cocktails. With 24-hour fitness access and a relaxed Kiwi atmosphere, voco combines elevated design with warm hospitality.

SOCIAL EVENT VENUES

Auckland Art Gallery Toi O Tāmaki



A beautiful, award-winning heritage building housing a permanent collection of New Zealand's most treasured artworks alongside dynamic, rotating exhibitions. The gallery seamlessly blends historic charm with vibrant contemporary spaces—from awe-inspiring rooms with expansive windows and unique installations to heritage rooms featuring decorative columns and corniced ceilings.

BANQUET: 130 COCKTAIL: 250

SOCIAL EVENT VENUES

Auckland Town Hall



Auckland Town Hall is a heritage venue of elegance and sophistication. Its Edwardian Baroque architecture, stained-glass windows, ornate plasterwork, and grand chandeliers create a stunning event backdrop. Home to one of the Southern Hemisphere's largest organs, it has welcomed dignitaries worldwide and remains one of Auckland's most iconic gala dinner spaces.

BANQUET: 350 COCKTAIL: 670

SOCIAL EVENT VENUES

Auckland War Memorial Museum Tāmaki Paenga Hira



Auckland Museum features striking neo-classical architecture and a commanding hilltop location, making it one of Auckland's premier heritage venues. Host cocktail receptions among majestic columns or dinners beneath the copper-domed roof with near 360-degree city views. With an experienced team and flexible catering options, Auckland Museum delivers outstanding, tailored events.

BANQUET: 450 COCKTAIL: 500

SOCIAL EVENT VENUES

Eden Park



Eden Park is New Zealand's most iconic stadium and the historic home of Auckland cricket and rugby for over a century. It offers versatile, light-filled event spaces, including the expansive Grand Hall. Elevate your event with stadium tours, access to players' areas, and the Hall of Legends. With expert event management, NZ's largest super screens, and free parking, Eden Park delivers unforgettable experiences in a legendary setting.

BANQUET: 800 COCKTAIL: 1500

SOCIAL EVENT VENUES

MOTAT (Museum of Transport & Technology)



MOTAT's Aviation Hall offers a unique venue for events amidst New Zealand's largest transport and technology museum. Guests can enjoy cocktails under the Avro Lancaster Bomber or dine beneath the Solent and Sunderland flying boats. It's an ideal setting for gala dinners and more.

BANQUET: 350 COCKTAIL: 500

SOCIAL EVENT VENUES

Shed 10



Built in 1910, heritage-listed Shed 10 once stored cargo for overseas shipment. Its restored ground floor retains industrial features like concrete floors and steel columns, while the upper floor showcases timber flooring. Today, it's a unique venue for dinner events, blending historic charm with versatile space.

BANQUET: 750 COCKTAIL: 2000

SOCIAL EVENT VENUES

St Matthew-in-the-city



St Matthew-in-the-City is a neo-Gothic stone landmark in the heart of Auckland city, built in 1905. Its soaring vaulted ceilings, stunning stained-glass windows, polished kauri finishes, and a majestic 3004-pipe organ create an unforgettable ambiance. The venue offers a dramatic and flexible canvas for gala dinners and elegant receptions—imbued with spiritual grandeur and architectural character.

BANQUET: 250 COCKTAIL: 450

SOCIAL EVENT VENUES

Viaduct Events Centre



The Viaduct Events Centre is set on Auckland's vibrant waterfront, with stunning views of the Waitematā Harbour and city skyline. With seven flexible spaces across three levels, it's an ideal venue for gala dinners or cocktail functions. Its standout space, the Waiheke Room, features 12-metre ceilings and glass walls that showcase the surrounding harbour.

BANQUET: 1200 COCKTAIL: 2000

SOCIAL EVENT VENUES

Wētā Workshop Unleashed



Step into the movie magic of Wētā Workshop Unleashed—creators behind cinematic icons like Avatar and The Lord of the Rings. This immersive experience transports guests into the worlds of horror, sci-fi, and fantasy—featuring a volcanic cavern, a towering galactic robot, and a miniature fantasy realm. A truly unique event setting, it's a place where imagination takes centre stage.

BANQUET: 240 COCKTAIL: 700

ACCOMMODATION

Unforgettable stays

In the heart of Auckland's vibrant city centre, you'll find more than 8,000 hotel rooms, many just a short walk from premier meeting venues, event spaces, top restaurants, lively bars, and renowned shopping precincts.

From globally recognised hotel brands to chic boutique options, Auckland offers accommodation to suit every style and budget.

Choose a waterfront hotel with stunning harbour views or unwind in a peaceful beachfront property, secluded forest retreat or clifftop lodge.

Many properties offer accessible options, ensuring a comfortable and inclusive stay for all guests.

Accommodation rates range from budget-friendly options at \$66-\$110 NZD, mid-range 4.5-star stays at \$240-\$300 NZD, and premium 5-star experiences starting at \$250 NZD and above.

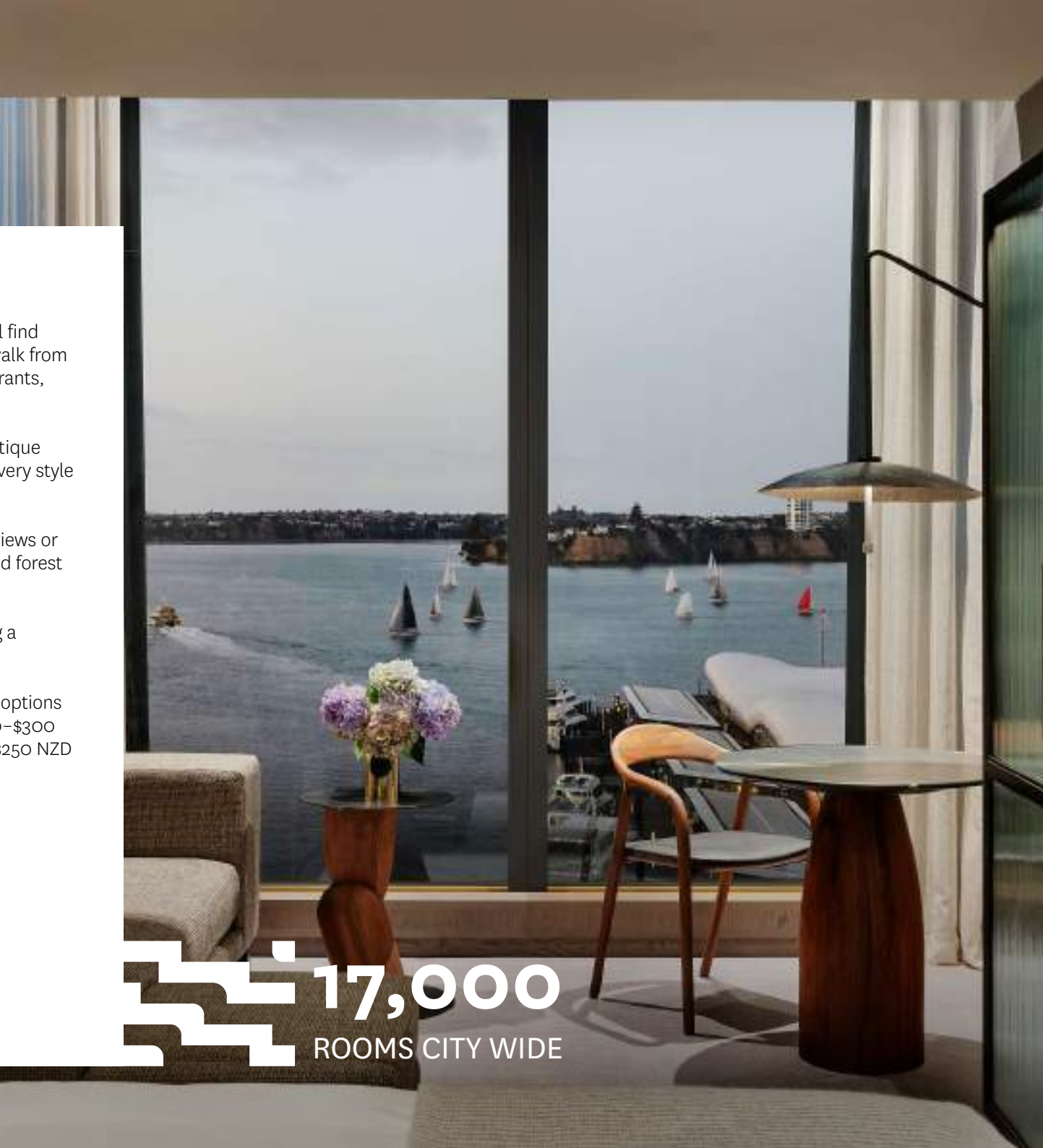

17,000
ROOMS CITY WIDE

PROXIMITY MAP

Everything close

Auckland's walkable City Centre is packed with a range of accommodation providers and dining precincts within close proximity to conference venues.

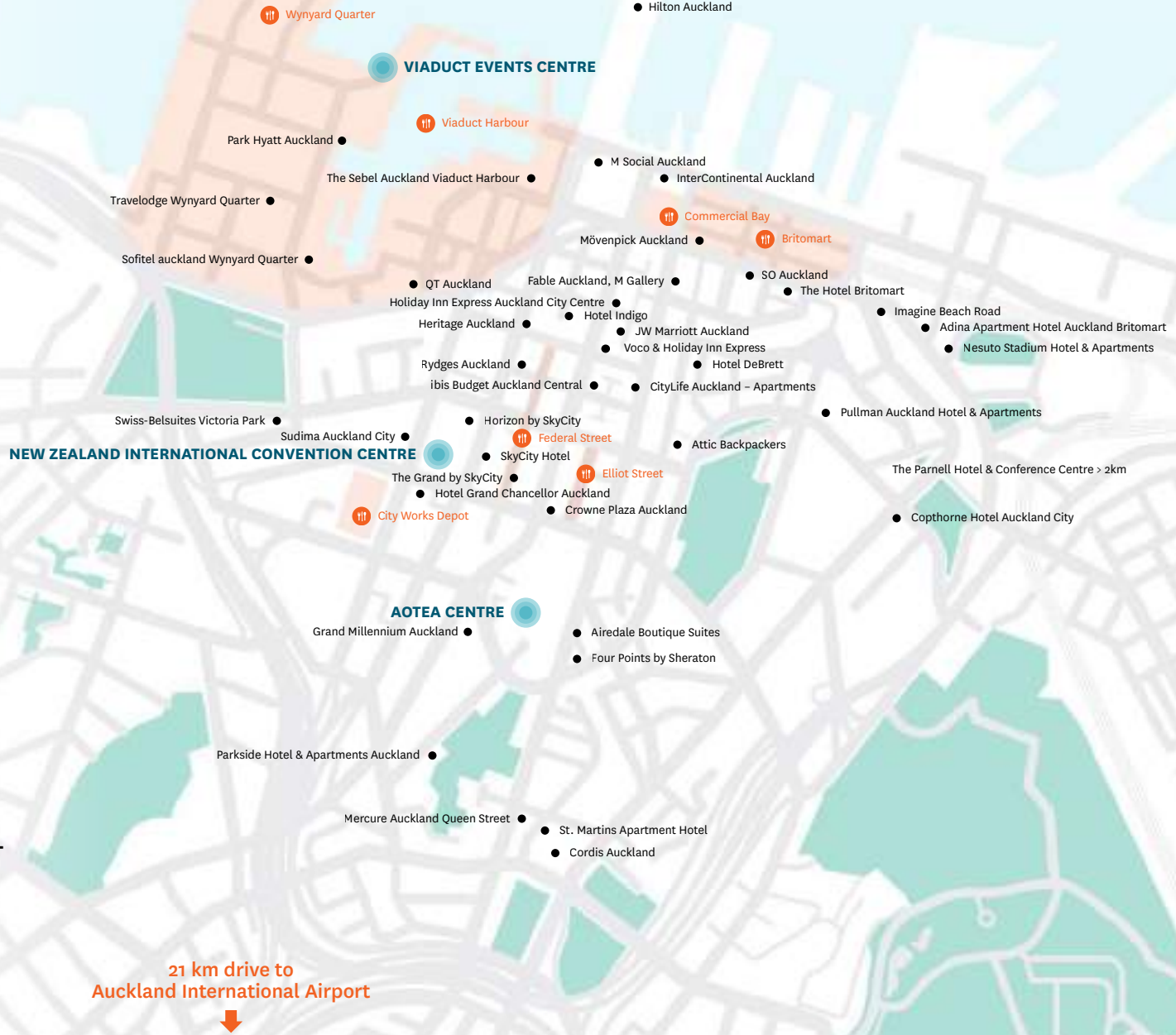

20 MIN DRIVE
FROM AUCKLAND
INTERNATIONAL AIRPORT
TO THE CENTRAL CITY

A truly unique lens on CSR

Environmental Initiatives

Auckland is home to diverse natural landscapes, from coastal shores to native bush. Delegates can take part in hands-on conservation efforts that connect them with the environment while leaving a positive impact on the region's ecology.

Cultural Engagement

Auckland's rich Māori heritage offers meaningful opportunities for cultural connection. Through community-focused projects, delegates can engage authentically with local traditions and contribute to initiatives that foster mutual respect and understanding.

Societal Support

For teams seeking purpose-driven activities, Auckland provides opportunities to support local communities in impactful ways. These experiences promote teamwork while giving back to causes that truly matter.

With a wide range of CSR options across the region, it's easy to create a program that aligns with your event values and fosters genuine engagement with Aotearoa, New Zealand.



CARING FOR NEW ZEALAND

Kaitiakitanga - caring for our environment

In New Zealand, we feel a special connection to the land and believe we have a duty of care to look after it for future generations.

New Zealand offers a wide range of solutions to help event organisers deliver events that protect the environment and leave positive impacts. These include:



Encouraging your delegates to embrace the Tiaki Promise, a commitment to care for New Zealand, for now and for future generations. Act as a guardian while in New Zealand and:

- Care for land, sea and nature, treading lightly and leaving no trace
- Travel safely, showing care and consideration for all
- Respect culture, travelling with an open heart and mind.



Choosing Qualmark accredited venues, accommodation and operators in New Zealand. Qualmark certified venues and activities are judged against criteria recognised by the Global Sustainable Tourism Council, meaning they meet global standards of sustainability across five key pillars: environment, people, community and culture, health and safety, and business systems.



EXPERIENCING MĀORI CULTURE

Cultural connection

New Zealand's unique identity is deeply shaped by its indigenous Māori culture, offering opportunities to incorporate rich, authentic experiences found nowhere else in the world.

Bringing te ao Māori—the Māori worldview—into your conference fosters deeper connection, encourages fresh thinking, and can lead to more meaningful outcomes for both hosts and delegates.

Ways to authentically integrate Māori culture include:

- Involving Māori representatives into the organising committee
- Weaving Mātauranga Māori (Māori knowledge) into the event programme
- Embedding Māori values throughout the event
- Opening with a pōwhiri or mihi whakatau (ceremonial welcome)
- Starting each day with a karakia (incantation or prayer)
- Engaging a Māori MC, facilitator, or guest speaker
- Select culturally significant venues or include a cultural performance
- Promote Māori tourism experiences before or after the event.



DINING

Restaurants



Ahi

A laid back and sophisticated food and wine experience, encapsulating the essence of New Zealand hospitality. Acclaimed chef Ben Bayly offers up a menu boasting New Zealand's finest ingredients, organic vegetables from Ahi's kitchen garden and a drinks list championing the best local wines and spirits.

 [Visit Website](#)



Ada

Ada is set in a beautifully restored former convent turned boutique bistro inside The Convent Hotel. Known for its soaring glass-ceilinged atrium and community-style long table seating, it serves inventive European-inspired cuisine with a Kiwi twist.

 [Visit Website](#)



Alma

Alma brings the bold, sun-soaked flavours of southern Spain to central Auckland. With a focus on wood-fired cooking and seasonal sharing plates, it offers a relaxed yet refined dining experience, complemented by a curated list of local and Spanish wines.

 [Visit Website](#)

DINING

Restaurants



Amano

Amano celebrates the best of New Zealand produce through an Italian lens, offering a daily-changing menu built around fresh, seasonal ingredients. Set in a stylish Britomart warehouse, it blends rustic charm with modern sophistication — from house-made pasta to artisan baked goods and a thoughtfully curated wine list.

 [Visit Website](#)



Baduzzi

Baduzzi brings a touch of Italian soul to Auckland's waterfront, serving handcrafted meatballs, fresh pasta, and wood-fired dishes in a warm, upscale setting. With its rich flavours, attentive service, and award-winning wine list, it's a modern homage to traditional Italian hospitality.

 [Visit Website](#)



Botswana Butchery

Set in a historic ornate building, Botswana Butchery delivers a luxurious dining experience with a focus on premium meats, seafood, and local produce. Known for its rich flavours, extensive wine list, and elegant yet relaxed atmosphere, it's a staple of refined New Zealand hospitality.

 [Visit Website](#)

DINING

Restaurants



Cassia

Cassia redefines modern Indian dining with bold, contemporary dishes that celebrate local New Zealand ingredients. Set in a sleek, urban space, it offers a refined yet vibrant experience, where tradition meets innovation through flavour, spice, and craft.



[Visit Website](#)



Cibo

Tucked away in Parnell, Cibo is a beloved Auckland institution known for its inventive, indulgent cuisine and effortlessly stylish setting. With a menu that blends bold flavours and playful twists, it offers a vibrant, upscale dining experience perfect for any occasion.



[Visit Website](#)



Culprit

Culprit brings bold, modern Kiwi dining to life with a menu inspired by local produce and big city energy. Served yum-cha style from the trolley, their inventive, ever-evolving dishes deliver a fun, flavour-packed experience in a moody, inner-city loft setting.



[Visit Website](#)

DINING

Restaurants



Gilt Brasserie

Located in the historic Chancery Chambers, Gilt Brasserie blends classic European flair with modern elegance. Offering refined bistro-style dishes, expertly crafted cocktails, and a polished atmosphere, it's a go-to for sophisticated dining in the heart of the city.



[Visit Website](#)



Harbourside

Harbourside offers stunning waterfront dining with a focus on fresh, sustainably sourced seafood and New Zealand produce. Set in a sleek, contemporary space, it delivers a relaxed yet refined experience, perfect for enjoying the city's harbour views alongside expertly crafted dishes.



[Visit Website](#)



Huami

Huami brings vibrant, modern Chinese flavours with a menu inspired by traditional techniques and fresh, local ingredients. Set in a stylish, lively space, it offers bold, authentic dishes that celebrate the richness of Chinese cuisine.



[Visit Website](#)

DINING

Restaurants



Kingi

Kingi celebrates seafood - local, sustainably caught seafood that tastes like the ocean it came from. Savour the terroir of New Zealand's oceans, dunes, river mouths and reefs, and enjoy a good glass of wine in this sophisticated space next to the Hotel Britomart.

 [Visit Website](#)



Masu

Masu delivers an authentic Japanese robata dining experience with a focus on premium ingredients and open-fire cooking. Set in a sleek, vibrant space, it's known for its bold flavours, expertly crafted dishes, and lively atmosphere.

 [Visit Website](#)



Metita

Metita offers a fresh take on Pacific Island cuisine, highlighting vibrant, bold flavours and seasonal New Zealand ingredients. With a relaxed, welcoming atmosphere, it's a celebration of culture, community, and shared dining.

 [Visit Website](#)

DINING

Restaurants



Mr Morris

A place to be served, nourished and indulged. Helmed by acclaimed chef Michael Meredith, the menu at Mr Morris offers local, ethical, sustainable and seasonal produce with a devotion to flavour, to create a modern Pacific and New Zealand experience in a relaxed, welcoming space.

 [Visit Website](#)



Onslow

Onslow is the culmination of chef Josh Emett's culinary journey from London to New York and back to Aotearoa, New Zealand. A landmark Auckland address steeped in history, Onslow references the Old World but is decidedly modern; a sophisticated yet relaxed restaurant that celebrates New Zealand's exceptional provenance.

 [Visit Website](#)



Origine

A modern French brasserie that meets New Zealand produce – to bring a unique French Kiwi dining experience from celebrity chef Ben Bayly. The Mezzanine floor has its private dining space with dedicated bar and bathroom facilities.

 [Visit Website](#)

DINING

Restaurants



Paris Butter

Paris Butter elegantly combines a fun and innovative yet refined ambience with a modern dining experience.

Sourcing the best produce in New Zealand with some of the best suppliers to give guests the most delicious balanced evolution menu over six or eight courses with a strong emphasis on seasons, textures and flavours.

 [Visit Website](#)



Sails Restaurant

Enjoy the view over thousands of yachts while tucking into their famed crayfish and seafood dishes. Over the last three decades, Sails has forged its reputation as one of New Zealand's top restaurants through an uncompromising belief in using only the freshest ingredients, the most talented chefs and professional waiting staff.

 [Visit Website](#)



Soul Bar and Bistro

SOUL's fresh and unpretentious food and irresistible hand-crafted cocktails deliver elegance and fun in equal measures. Boasting spectacular sunset views looking out over Auckland's thriving Viaduct Harbour, SOUL has achieved the rare feat of being all things to all people.

 [Visit Website](#)

NATIONAL CARRIER

Air New Zealand

Air New Zealand has a proud history as New Zealand's national carrier, connecting New Zealand to the world.



Embedded in their purpose, is the promise of Manaaki – taking care further than any other airline. This idea of care is encapsulated in Air New Zealand's values and surrounds everything they do – from taking care of each other, customers, communities and the environment. The airline's strong corporate brand and renowned Kiwi service culture continues to drive loyalty and engagement, and is internationally recognised with awards won in 2024 including:

World's Safest Airline

[Airlineratings.com](https://www.airlinerratings.com)

New Zealand's Employer of the Year

[Randstad Award](https://www.randstad.com)

Best Economy Class

[Airlineratings.com](https://www.airlinerratings.com)

Best Business Class Lounge
in Australia and Pacific

[Auckland International Airport — Skytrax Awards](https://www.skytrax.com)



TRACK RECORD

Event success

Auckland has an impressive track record of securing and hosting successful major and business events.

Recent successes and upcoming events include:

Major Events & Association Conferences

Women's Rugby World Cup

October 2022

FIFA Women's World Cup

July 2023

World Indigenous Peoples Conference on Education

November 2025 · 4,000 delegates

2026 ANZCA Annual Scientific Meeting (ASM)

May 2026 · 1600 delegates

The FAOPMA Pest Summit

July 2026 · 1000 delegates

16th International Coral Reef Symposium (ICRS)

July 2026 · 2000 delegates

The 20th International Symposium on Microbial Ecology

August 2026 · 2000 delegates

International Dairy Federation World Summit

November 2026 · 1,500 delegates



INDUSTRIES

Sectors of expertise

Tech

Auckland is a fast-growing tech hub, excelling in AI, fintech, and healthtech. A strong startup culture, skilled talent, and top universities drive innovation and global partnerships.

Creative

Renowned for film, gaming, and design, Auckland blends cultural richness with world-class talent.

Advanced Materials

Auckland pioneers advanced materials for aerospace, marine, and medical use, with strengths in composites and nanotech supported by leading research institutions.

Circular Economy

Championing circular economy solutions through waste reduction, recycling innovation, and sustainable design, backed by policy and collaborative industry efforts.

Building and Infrastructure

Auckland leads in sustainable infrastructure and urban design, integrating smart tech to build resilient, future-ready spaces.

Food & Beverage

Auckland's F&B sector delivers high-value, export-ready products, combining agri-tech innovation, food safety, and multicultural culinary creativity.

Aerospace

With innovators like Rocket Lab, Auckland is a rising aerospace leader with strong R&D support.

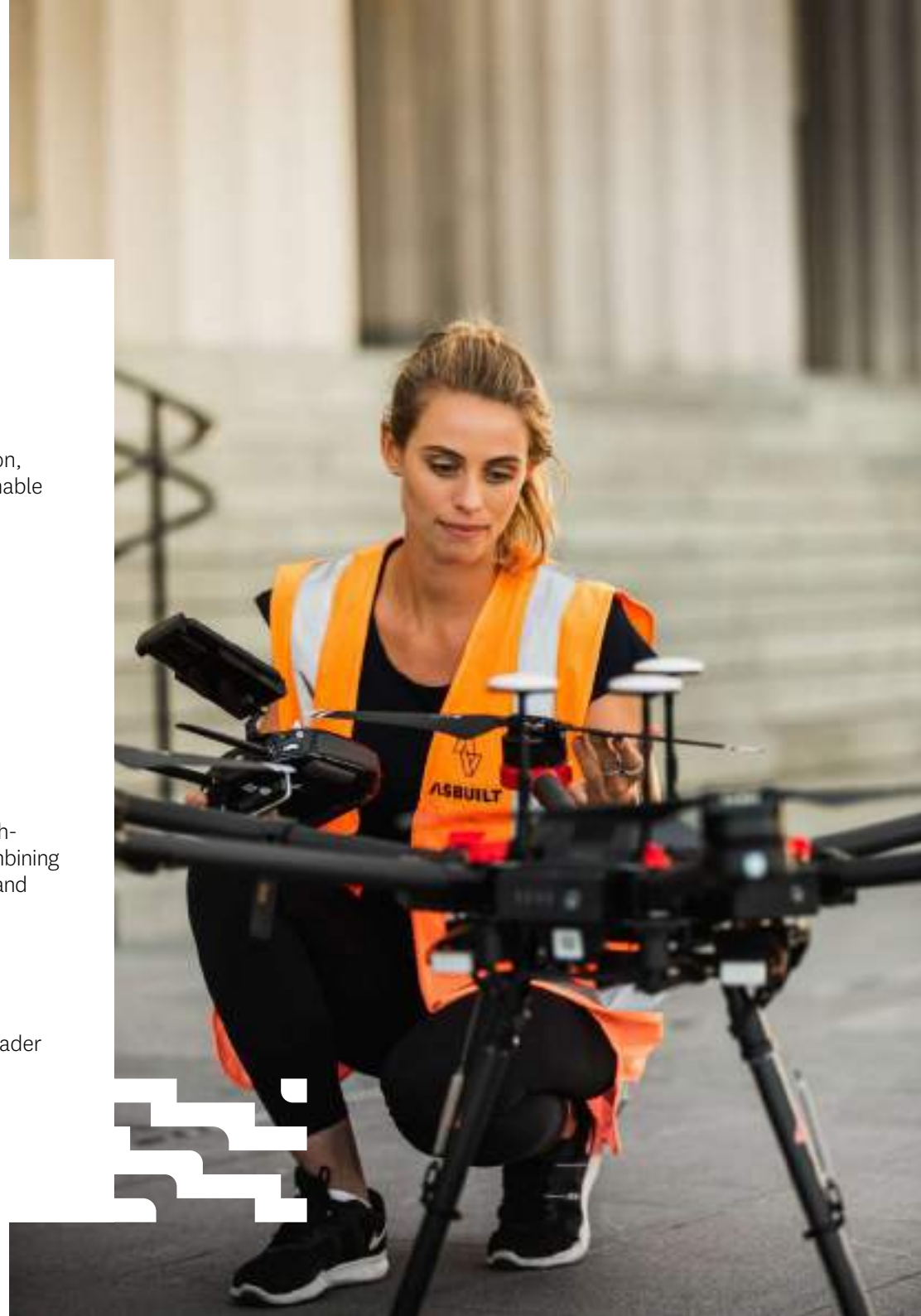

WHAT PEOPLE SAY

Testimonials



“The warmth and genuine hospitality of everyone we encountered made a lasting impression”

“There was so much to see and experience in Auckland. I was so impressed by the city”

“Dedicated support from the Auckland Convention Bureau ensured a seamless and impactful experience”

“Auckland has the capacity to accommodate groups of 500+ in terms of meeting spaces and accommodation all within close proximity”

“The fusion of Māori and Western cuisine adds a new dimension to its culinary scene—about storytelling and cultural connection”

“A great city which is easily accessible. Travel from the USA was seamless”

EXPERIENCE AUCKLAND



From sparkling harbours and lush native forests to nearby islands and world-class vineyards, adventure awaits at every turn. Enjoy the golden tranquillity of the eastern beaches or explore the rugged beauty of the black sand shores on the west coast. With something for everyone, Auckland is the perfect destination for exploration and discovery.

EXPERIENCE NEW ZEALAND



Waikato



Rotorua



Taupō



Wellington



Nelson



Marlborough



Christchurch



Queenstown



Dunedin

With scenery that takes your breath away, world-class food and wine, and unique visitor experiences, New Zealand offers the perfect way to get away from it all, or go on an epic adventure.

CLOSING STATEMENT

Our expert team is here to help you deliver an exceptional experience—one that will surprise and delight your delegates at every turn.

We look forward to partnering with you to make it truly unforgettable.

Contact us today at: meet@aucklandnz.com



